

Product Summary

MOSFET		
$V_{(BR)DSS}$	$R_{DS(on) \max}$	I_D
-20V	85mΩ @ $V_{GS} = -10V$	-3.3A
	125mΩ @ $V_{GS} = -4.5V$	-2.8A
SCHOTTKY DIODE		
V_R	$V_F \max$	I_O
20V	400mV @ $I_F = 0.5A$	1.0A
	470mV @ $I_F = 1.0A$	

Description

This new generation MOSFET has been designed to minimize the on-state resistance ($R_{DS(ON)}$) and yet maintain superior switching performance, making it ideal for high efficiency power management applications.

Applications

- DC-DC Converters
- Power Management Functions
- Backlighting

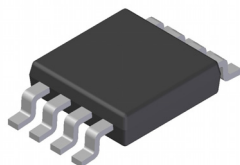

Top View

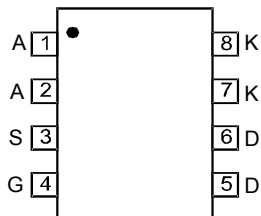

Top View
Internal Schematic

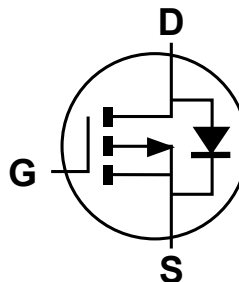

Q1 P-Channel MOSFET



D1 Schottky Diode

Features and Benefits

- Low Input Capacitance
- MOSFET with Low $R_{DS(ON)}$ – Minimize Conduction Losses
- Schottky Diode with Low Forward Voltage Drop
- Fast Switching Speed
- **Totally Lead-Free & Fully RoHS Compliant (Notes 1 & 2)**
- **Halogen and Antimony Free. "Green" Device (Note 3)**
- **Qualified to AEC-Q101 Standards for High Reliability**

Mechanical Data

- Case: SO-8
- Case Material: Molded Plastic, "Green" Molding Compound. UL Flammability Classification Rating 94V-0
- Moisture Sensitivity: Level 1 per J-STD-020
- Terminal Connections: See Diagram
- Terminals: Finish – Matte Tin annealed over Copper leadframe Solderable per MIL-STD-202, Method 208 e3
- Weight: 0.074 grams (approximate)

Ordering Information (Note 4)

Part Number	Case	Packaging
DMS2085LSD-13	SO-8	2,500/Tape & Reel

- Notes:
1. No purposely added lead. Fully EU Directive 2002/95/EC (RoHS) & 2011/65/EU (RoHS 2) compliant.
 2. See http://www.diodes.com/quality/lead_free.html for more information about Diodes Incorporated's definitions of Halogen- and Antimony-free, "Green" and Lead-free.
 3. Halogen- and Antimony-free "Green" products are defined as those which contain <900ppm bromine, <900ppm chlorine (<1500ppm total Br + Cl) and <1000ppm antimony compounds.
 4. For packaging details, go to our website at <http://www.diodes.com/products/packages.html>.

Marking Information

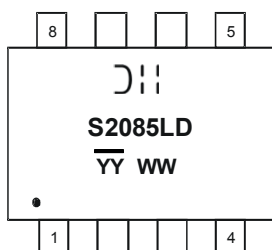

Chengdu A/T Site

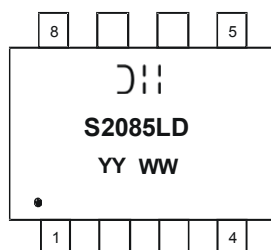

Shanghai A/T Site

- ⌋⌋⌋ = Manufacturer's Marking
- S2085LD = Product Type Marking Code
- YYWW = Date Code Marking
- YY or YY = Year (ex: 13 = 2013)
- WW = Week (01 - 53)
- YY = Date Code Marking for SAT (Shanghai Assembly/ Test site)
- YY = Date Code Marking for CAT (Chengdu Assembly/ Test site)

Maximum Ratings – P-CHANNEL MOSFET – Q1 (@T_A = +25°C, unless otherwise specified.)

Characteristic			Symbol	Value	Units
Drain-Source Voltage			V _{DSS}	-20	V
Gate-Source Voltage			V _{GSS}	±20	V
Continuous Drain Current (Note 6) V _{GS} = 10V	Steady State	T _A = +25°C T _A = +70°C	I _D	-3.3 -2.7	A
	t<10s	T _A = +25°C T _A = +70°C	I _D	-4.3 -3.4	A
Maximum Body Diode Forward Current (Note 6)			I _S	-1.5	A
Pulsed Drain Current (10µs pulse, duty cycle = 1%)			I _{DM}	-11.2	A
Avalanche Current (Notes 7) L = 5mH			I _{AR}	-5	A
Avalanche Energy (Notes 7) L = 5mH			E _{AR}	50	mJ

Maximum Ratings – SCHOTTKY – D1 (@T_A = +25°C, unless otherwise specified.)

Characteristic	Symbol	Value	Unit
Peak Repetitive Reverse Voltage	V _R RM	20	V
Working Peak Reverse Voltage	V _R WM		
DC Blocking Voltage	V _R		
Average Rectified Output Current (Note 7, t<10s)	I _O	1	A
Peak Repetitive Forward Current (Note 7, t<10s)	I _{FRM}	2	A
Non-Repetitive Peak Forward Surge Current (Note 7, t<10s) Single half sine-wave superimposed on rated load	I _{FSM}	20	A

Thermal Characteristics (@T_A = +25°C, unless otherwise specified.)

Characteristic	Symbol	Value	Units
Total Power Dissipation (Note 5)	P _D	T _A = +25°C	1.1
		T _A = +70°C	1.8
Thermal Resistance, Junction to Ambient (Note 5)	R _{θJA}	Steady state	108
		t<10s	65
Total Power Dissipation (Note 6)	P _D	T _A = +25°C	1.8
		T _A = +70°C	2.3
Thermal Resistance, Junction to Ambient (Note 6)	R _{θJA}	Steady state	78
		t<10s	50
Thermal Resistance, Junction to Case (Note 6)	R _{θJC}	22	°C/W
Operating and Storage Temperature Range	T _J , T _{STG}	-55 to +150	

Electrical Characteristics P-Channel Q1 (@ $T_A = +25^\circ\text{C}$, unless otherwise specified.)

Characteristic	Symbol	Min	Typ	Max	Unit	Test Condition
OFF CHARACTERISTICS (Note 8)						
Drain-Source Breakdown Voltage	BV_{DSS}	-20	—	—	V	$V_{GS} = 0V, I_D = -250\mu A$
Zero Gate Voltage Drain Current	I_{DSS}	—	—	-1	μA	$V_{DS} = -20V, V_{GS} = 0V$
Gate-Source Leakage	I_{GSS}	—	—	± 100	nA	$V_{GS} = \pm 20V, V_{DS} = 0V$
ON CHARACTERISTICS (Note 8)						
Gate Threshold Voltage	$V_{GS(th)}$	-0.5	-1.5	-2.2	V	$V_{DS} = V_{GS}, I_D = -250\mu A$
Static Drain-Source On-Resistance	$R_{DS(on)}$	—	70	85	m Ω	$V_{GS} = -10V, I_D = -3.05A$
		—	100	125		$V_{GS} = -4.5V, I_D = -1.50A$
Diode Forward Voltage	V_{SD}	—	-0.8	-1.0	V	$V_{GS} = 0V, I_S = -1.0A$
DYNAMIC CHARACTERISTICS (Note 9)						
Input Capacitance	C_{iss}	—	353	—	pF	$V_{DS} = -15V, V_{GS} = 0V$ $f = 1.0MHz$
Output Capacitance	C_{oss}	—	49	—		
Reverse Transfer Capacitance	C_{rss}	—	41	—		
Gate Resistance	R_G	—	6.2	—	Ω	$V_{DS} = 0V, V_{GS} = 0V, f = 1.0MHz$
Total Gate Charge ($V_{GS} = -4.5V$)	Q_g	—	3.7	—	nC	$V_{DS} = -15V, I_D = -3A$
Total Gate Charge ($V_{GS} = -10V$)	Q_g	—	7.8	—		
Gate-Source Charge	Q_{gs}	—	1.1	—		
Gate-Drain Charge	Q_{gd}	—	1.3	—		
Turn-On Delay Time	$t_{D(on)}$	—	3.3	—	nS	$V_{DS} = -15V, R_L = 15\Omega$ $V_{GS} = -10V, R_G = 6\Omega$
Turn-On Rise Time	t_r	—	3.0	—		
Turn-Off Delay Time	$t_{D(off)}$	—	14	—		
Turn-Off Fall Time	t_f	—	6.8	—		
Body Diode Reverse Recovery Time	t_{rr}	—	33	—	nS	$I_S = -3.05A, dI/dt = 100A/\mu s$
Body Diode Reverse Recovery Charge	Q_{rr}	—	46	—	nC	$I_S = -3.05A, dI/dt = 100A/\mu s$

- Notes:
- Device mounted on FR-4 substrate PC board, 2oz copper, with minimum recommended pad layout.
 - Device mounted on FR-4 substrate PC board, 2oz copper, with 1inch square copper plate.
 - I_{AS} and E_{AS} rating are based on low frequency and duty cycles to keep $T_J = +25^\circ\text{C}$
 - Short duration pulse test used to minimize self-heating effect.
 - Guaranteed by design. Not subject to product testing.

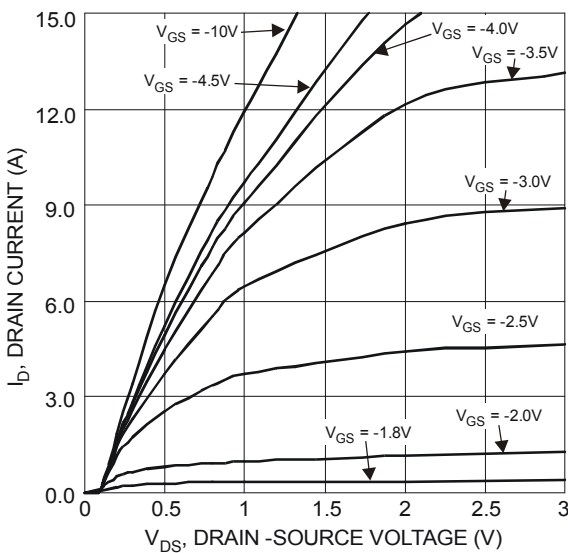

Figure 1 Typical Output Characteristics

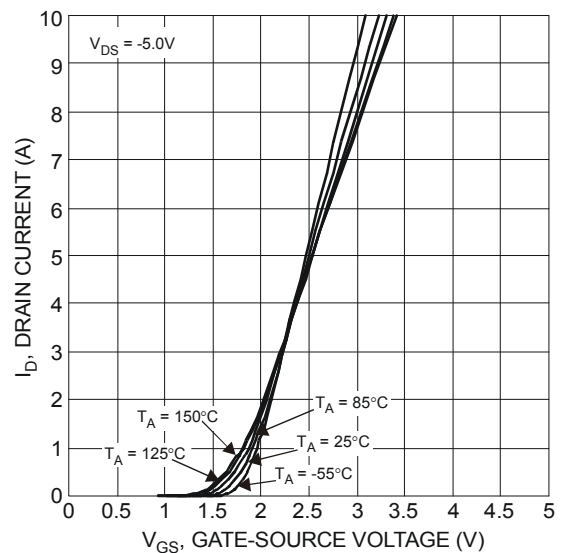

Figure 2 Typical Transfer Characteristics

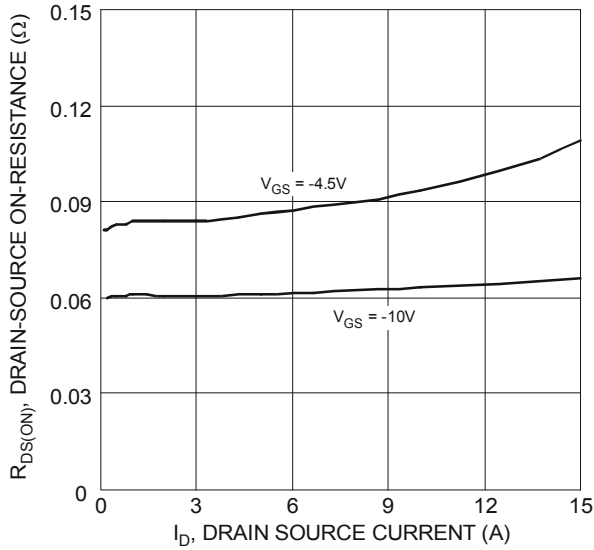

Figure 3 Typical On-Resistance vs. Drain Current and Gate Voltage

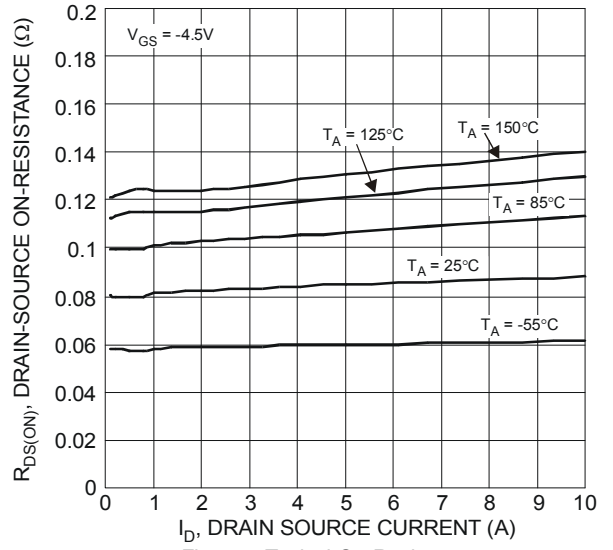

Figure 4 Typical On-Resistance vs. Drain Current and Temperature

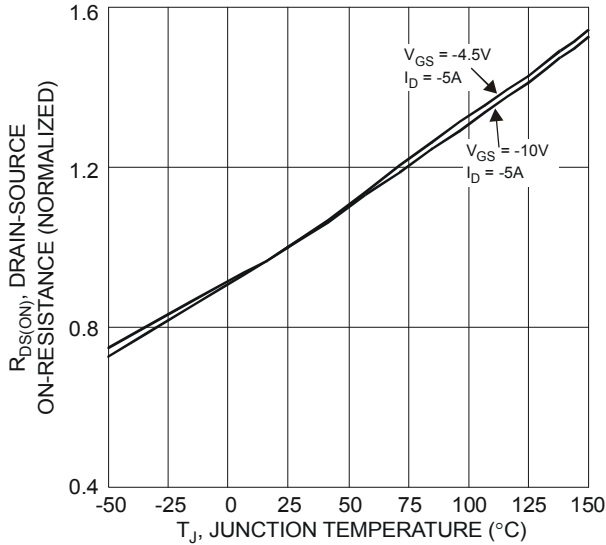

Figure 5 On-Resistance Variation with Temperature

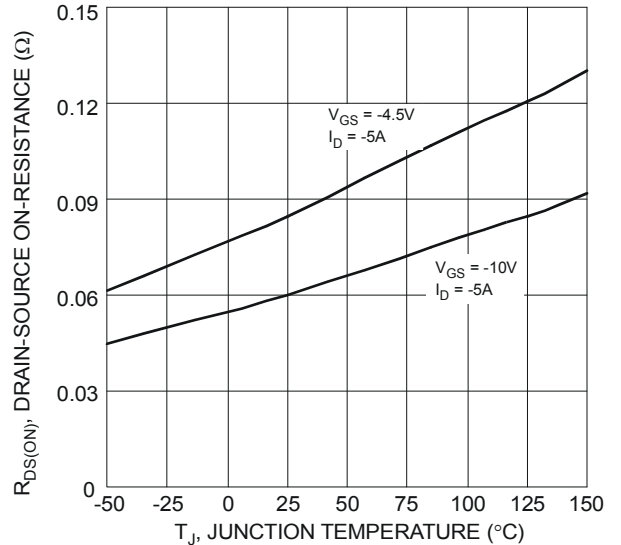

Figure 6 On-Resistance Variation with Temperature

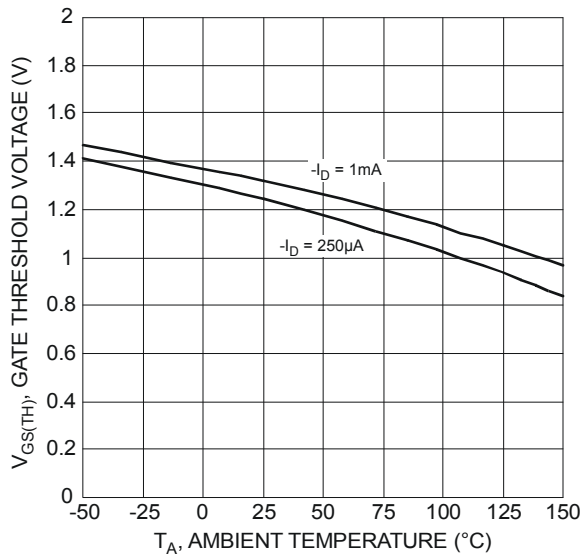

Figure 7 Gate Threshold Variation vs. Ambient Temperature

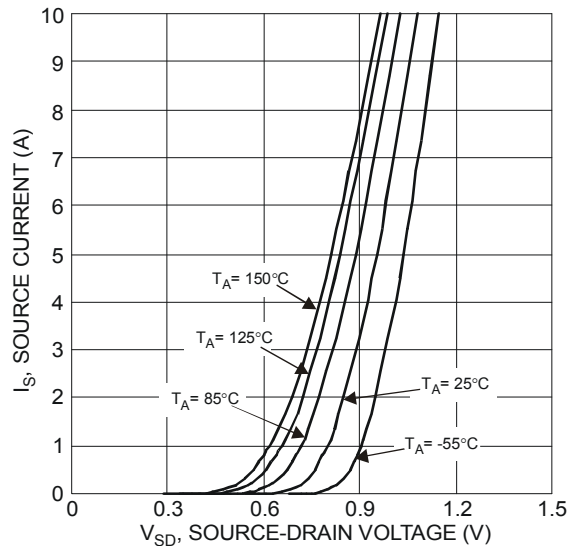
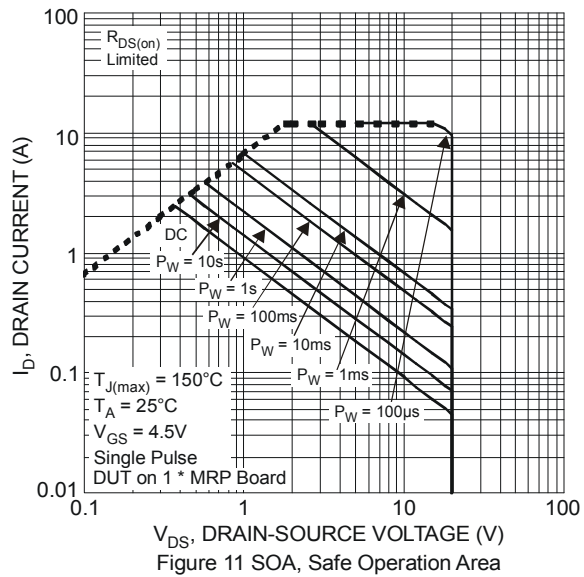
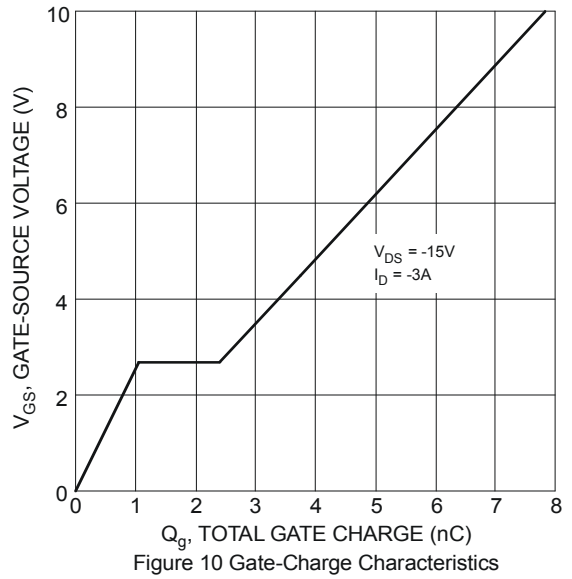
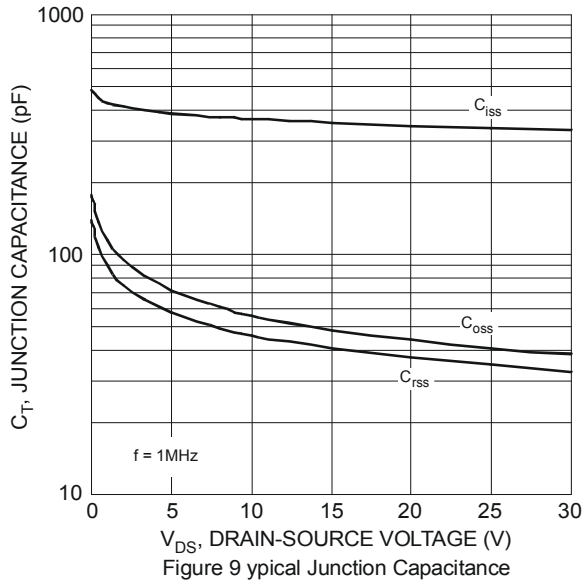

Figure 8 Diode Forward Voltage vs. Current



Electrical Characteristics – SCHOTTKY – D1 (@ $T_A = +25^\circ\text{C}$, unless otherwise specified.)

Characteristic	Symbol	Min	Typ	Max	Unit	Test Condition
Reverse Breakdown Voltage (Note 8)	$V_{(BR)R}$	20	35	—	V	$I_R = 1\text{mA}$
Forward Voltage (Note 8)	V_F	—	—	0.40 0.47	V	$I_F = 0.5\text{A}$ $I_F = 1.0\text{A}$
Reverse Current (Note 8)	I_R	—	30	80	μA	$V_R = 20\text{V}$

Notes: 8. Short duration pulse test used to minimize self-heating effect.

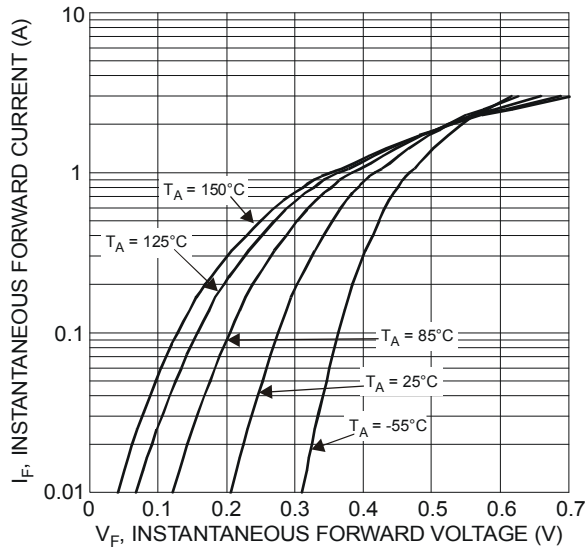

Figure 12 Typical Forward Characteristics

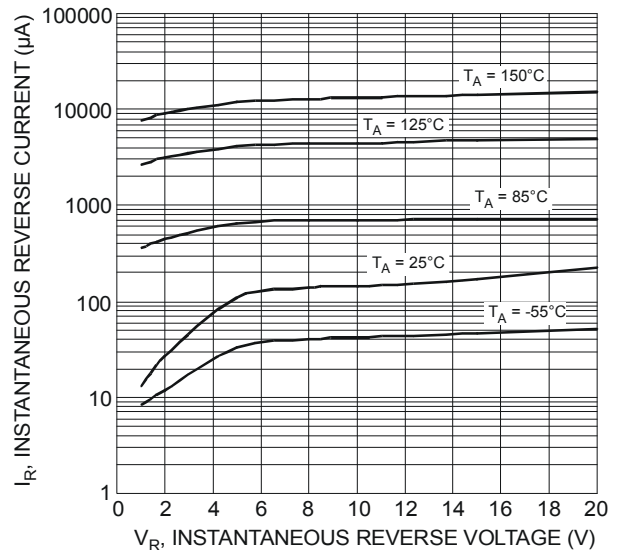
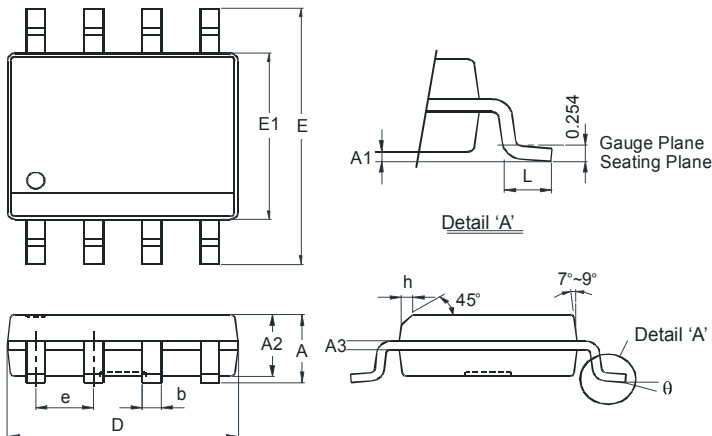

Figure 13 Typical Reverse Characteristics

Package Outline Dimensions

Please see AP02002 at <http://www.diodes.com/datasheets/ap02002.pdf> for latest version.



SO-8		
Dim	Min	Max
A	-	1.75
A1	0.10	0.20
A2	1.30	1.50
A3	0.15	0.25
b	0.3	0.5
D	4.85	4.95
E	5.90	6.10
E1	3.85	3.95
e	1.27 Typ	
h	-	0.35
L	0.62	0.82
θ	0°	8°
All Dimensions in mm		

Suggested Pad Layout

Please see AP02001 at <http://www.diodes.com/datasheets/ap02001.pdf> for the latest version.

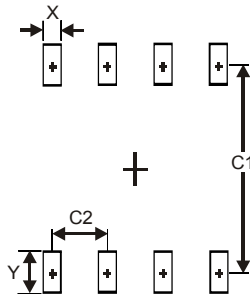

Dimensions	Value (in mm)
X	0.60
Y	1.55
C1	5.4
C2	1.27

IMPORTANT NOTICE

DIODES INCORPORATED MAKES NO WARRANTY OF ANY KIND, EXPRESS OR IMPLIED, WITH REGARDS TO THIS DOCUMENT, INCLUDING, BUT NOT LIMITED TO, THE IMPLIED WARRANTIES OF MERCHANTABILITY AND FITNESS FOR A PARTICULAR PURPOSE (AND THEIR EQUIVALENTS UNDER THE LAWS OF ANY JURISDICTION).

Diodes Incorporated and its subsidiaries reserve the right to make modifications, enhancements, improvements, corrections or other changes without further notice to this document and any product described herein. Diodes Incorporated does not assume any liability arising out of the application or use of this document or any product described herein; neither does Diodes Incorporated convey any license under its patent or trademark rights, nor the rights of others. Any Customer or user of this document or products described herein in such applications shall assume all risks of such use and will agree to hold Diodes Incorporated and all the companies whose products are represented on Diodes Incorporated website, harmless against all damages.

Diodes Incorporated does not warrant or accept any liability whatsoever in respect of any products purchased through unauthorized sales channel. Should Customers purchase or use Diodes Incorporated products for any unintended or unauthorized application, Customers shall indemnify and hold Diodes Incorporated and its representatives harmless against all claims, damages, expenses, and attorney fees arising out of, directly or indirectly, any claim of personal injury or death associated with such unintended or unauthorized application.

Products described herein may be covered by one or more United States, international or foreign patents pending. Product names and markings noted herein may also be covered by one or more United States, international or foreign trademarks.

This document is written in English but may be translated into multiple languages for reference. Only the English version of this document is the final and determinative format released by Diodes Incorporated.

LIFE SUPPORT

Diodes Incorporated products are specifically not authorized for use as critical components in life support devices or systems without the express written approval of the Chief Executive Officer of Diodes Incorporated. As used herein:

- A. Life support devices or systems are devices or systems which:
1. are intended to implant into the body, or
 2. support or sustain life and whose failure to perform when properly used in accordance with instructions for use provided in the labeling can be reasonably expected to result in significant injury to the user.
- B. A critical component is any component in a life support device or system whose failure to perform can be reasonably expected to cause the failure of the life support device or to affect its safety or effectiveness.

Customers represent that they have all necessary expertise in the safety and regulatory ramifications of their life support devices or systems, and acknowledge and agree that they are solely responsible for all legal, regulatory and safety-related requirements concerning their products and any use of Diodes Incorporated products in such safety-critical, life support devices or systems, notwithstanding any devices- or systems-related information or support that may be provided by Diodes Incorporated. Further, Customers must fully indemnify Diodes Incorporated and its representatives against any damages arising out of the use of Diodes Incorporated products in such safety-critical, life support devices or systems.

Copyright © 2014, Diodes Incorporated

www.diodes.com

Mouser Electronics

Authorized Distributor

Click to View Pricing, Inventory, Delivery & Lifecycle Information:

[Diodes Incorporated:](#)

[DMS2085LSD-13](#)